

REVISION RECORD			
REV.	CONTENT	MOD.	DATE
△	初版发行		

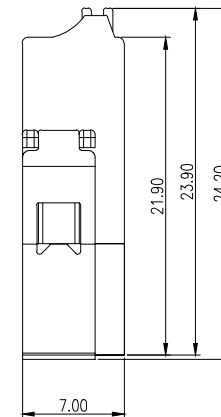
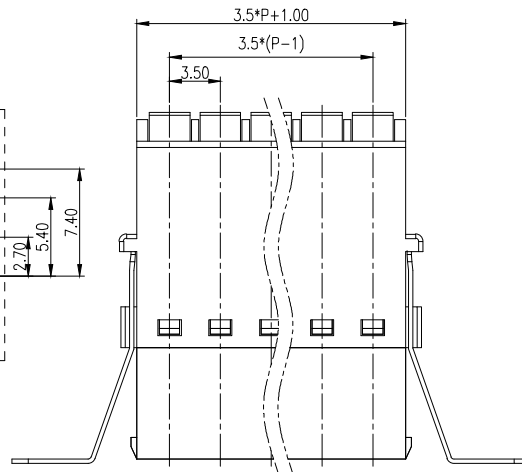
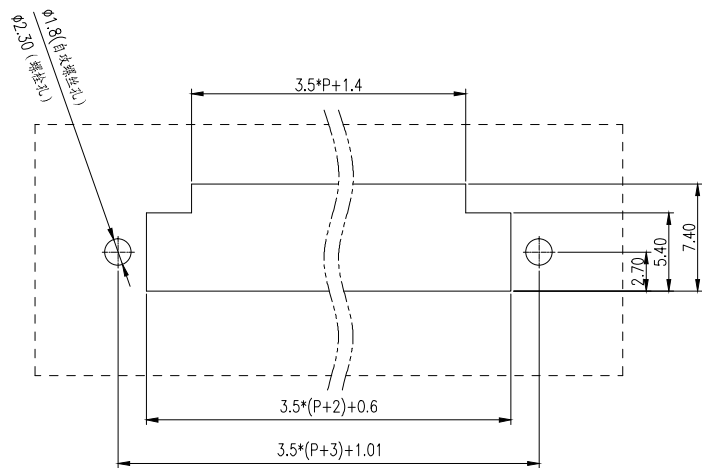
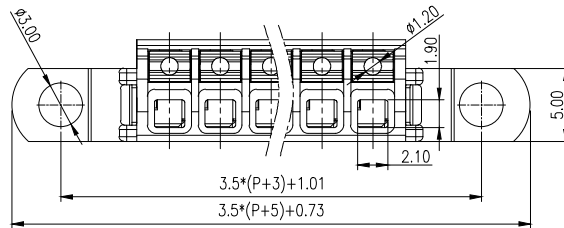
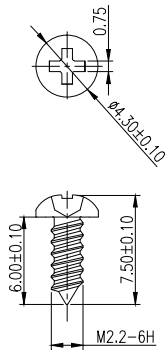

技术要求:  
 间距: 3.5mm  
 额定电流: 9.5 A  
 额定电压: 300 V  
 耐压值: AC 2000V/min  
 位数: 2~24

连接方式: 直插式弹簧连接  
 可连接导向横截面 AWG / kcmil 24-16  
 带不含绝缘套管的冷压头 0.25 mm<sup>2</sup> ~ 1.5 mm<sup>2</sup>  
 带套管, 带塑料绝缘套管 0.14 mm<sup>2</sup> ~ 0.75 mm<sup>2</sup>  
 剥线长度: 10 mm  
 使用条件: -40°C ~ +105°C

拔出测试  
 导线横截面 / 导线类型 / 拉力  
 0.2 mm<sup>2</sup> / 刚性 / > 10 N  
 0.2 mm<sup>2</sup> / 柔性 / > 10 N  
 1.5 mm<sup>2</sup> / 刚性 / > 40 N  
 1.5 mm<sup>2</sup> / 柔性 / > 40 N

	pitch dimension			Nominal dimension					— ▱ ⤿
	over 0	over 6	over 10	over 0	over 30	over 60	over 100	over 150	
variable range	to 6	to 10	to 24	to 30	to 60	to 100	to 150		
Tolerance	±0.1	±0.15	±0.25	±0.2	±0.3	±0.5	±0.7	±1.0	0.05/10

7	M2.2*6圆头自攻螺丝	SQZSA226509V	2	碳钢	蓝白锌
6	LC8-3.5穿墙件	1268B0YXXAV	2	SUS301	
5	AZ80-3.5针	1240B8035AV	2	磷青铜	镀亮锡
4	AZ8-3.5弹片	F2A0DAZ835BV	P	不锈钢	
3	LC8-3.5按钮	1188D5001AV	P	POM	
2	AZ80-3.5盖板	1240C0YXXAV	1	PA66	
1	LC8M-3.5主体	1188M0YXXAV	1	PA66	
NO.	NAME OF PART	NO. OF PART	Q'TY	MATERIAL	NOTES
DES.	吴央阳	DATE	24/02/02	UNITS	mm
CHK.	张华丰	DATE	24/02/02	SIZE	A4
APP.		DATE		SCALE	1:1
				DWG NO.	SP-2-1172001
				REV.	V0
上海联捷电气有限公司 Shanghai Elinker Electric CO.,LTD				TITLE	LC80C-3.5-XXP-1Y-00A LC80C-3.5-成品