

REVISION RECORD		
REV.	CONTENT	MOD. DATE
①	初版发行	

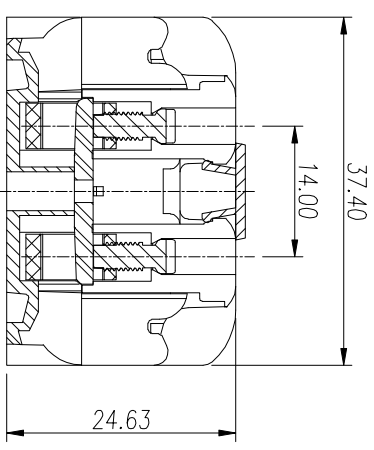
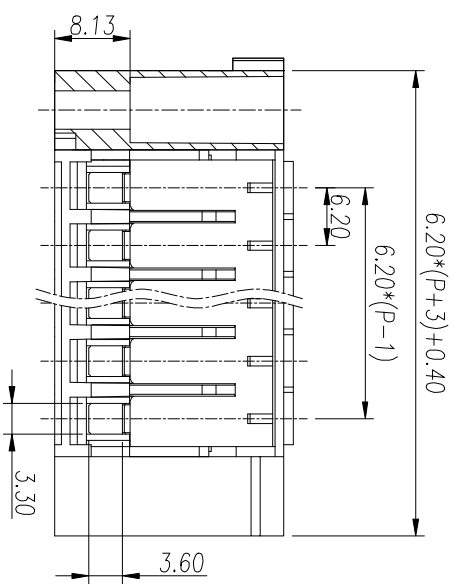
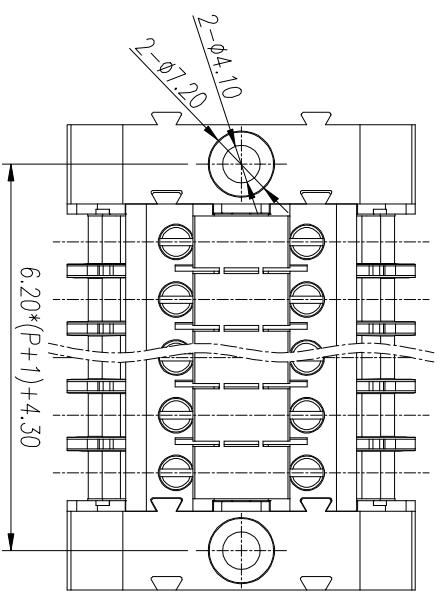

- NOTES:**
1. Voltage Rating: 800V, Current Rating: 41A
 2. PITCH: 6.20mm
 3. Insulation Withstands Voltage: AC3500V/min
 4. Insulation Resistance: 500MΩ or more at DC1000V
 5. Using Temperature Range: -40° C+105° C
 6. Suitable Electric Wire: 0.2-4.0mm²
 7. Screw Torque Value: 0.5 N.m
- 技术要求:**
1. 额定电压: 800V, 额定电流: 41A
 2. 间距: 6.20mm
 3. 耐受电压: AC 3500V/min
 4. 绝缘阻抗: 500兆欧
 5. 使用条件: -40° - +105°
 6. 刚柔性导线: 0.2-4.0mm²
 7. 螺丝扭力: 0.5 N.m

	pitch dimension			Nominal dimension					
	over	over	over	over	over	over	over	over	over
variable range	0 to 6	6 to 10	10 to 24	0 to 30	30 to 60	60 to 100	100 to 150	150	
Tolerance	±0.1	±0.15	±0.25	±0.2	±0.3	±0.5	±0.7	±1.0	0.05/10

7	LD1-2.5M	6LD11400253Y	2	PA66	
6	ZB6标识条	ZB6标识条	P/10		
5	US1V-导电件	6US3B00001AV	P	黄铜	镀锌
4	US1V-铜方块	F000000140V	2P	黄铜	镀锌
3	UK2-5P-螺丝	SSM0300070V	2P	合金钢	镀锌
2	LDK-盖板	6LDK0Y0X3Y	1	PA66	
1	LDK-主体	6LDK0Y0X3Y	1	PA66	
NO.	NAME OF PART	NO. OF PART	Q'TY	MATERIAL	NOTES
DRS.	ZD	DATE	2020/04/25	UNITS	MM
CHK.		DATE		SIZE	A4
APP.		DATE		SCALE	1:1
				THIRD ANGLE PROJECTION	SHEET
				DWG NO.	SP-1-JDK1400
				TITLE	LDKM-2.5/XT-TT-01B
					LDKM-2.5端子



上海联接电气有限公司
Shanghai Hinder Electric Co., Ltd